



# TO LET

Prime retail unit

## 1,618 sq.ft

(150 sq.m)

**Unit 1 Severn Square, Institute Lane, Alfreton,  
Derbyshire DE55 7BQ**

- Pedestrianised town centre location
- Prominent corner position
- Opposite Wilko and Home Bargains

**LCP.**  
part of M'Core

**01384  
400123**

[searchlcp.co.uk](http://searchlcp.co.uk)





## Unit 1 Severn Square, Institute Lane, Alfreton, Derbyshire DE55 7BQ

| Areas (approx. NIA) | Sq.ft        | Sq.m       |
|---------------------|--------------|------------|
| Ground Floor Sales  | 1,618        | 150        |
| <b>TOTAL</b>        | <b>1,618</b> | <b>150</b> |

### Description

The premises are arranged over ground floor providing open plan sales area, a small staff kitchen and WC. The property benefits from rear loading accessed from Hall Street. The property lies in the heart of the town centre on pedestrianised Institute Lane fronting Severn Square and just a short distance from High Street. Severn Square car park sits adjacent to the property and provides 127 spaces at low cost parking

### Rent

£22,000 pa exclusive of VAT, service charge and business rates.



### Rates

Rateable value: £16,250. Interested parties should satisfy themselves as to the Rateable value, the availability of any relief and the actual rates payable by making their own enquiries to the business rates department of the Local Authority.

### Service Charge & Insurance

A service charge of £1,478 + VAT per annum will be payable for the upkeep and maintenance of the communal aspects of the scheme. The landlord insures the structure and recovers the cost of the premium from the tenant.

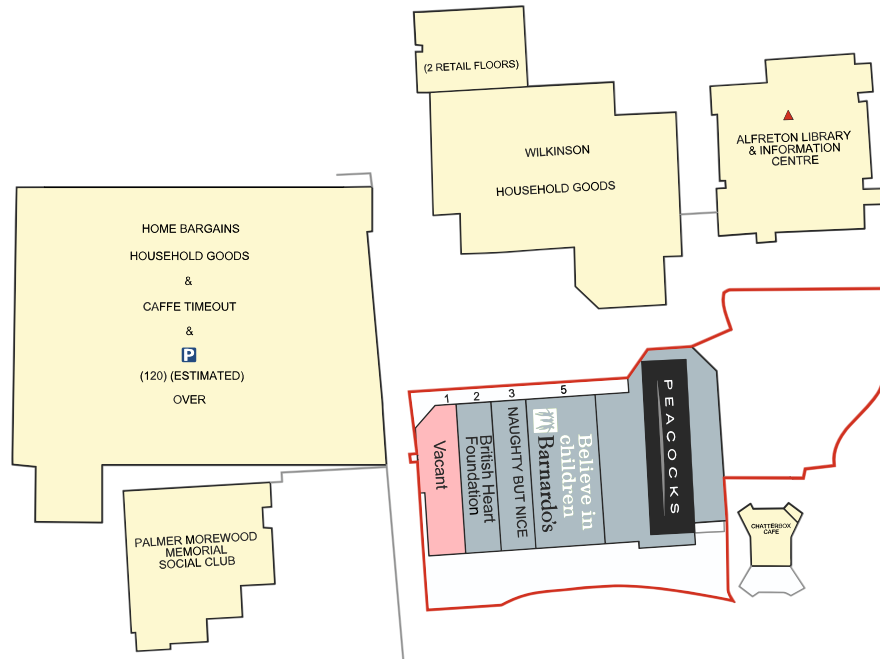

### Energy Performance

D-79. Further information available on request.

### Planning

An incoming tenant must satisfy themselves that their proposed use is acceptable to the Local Planning Authority.

### Legal Costs

Each party is to be responsible for their own legal and professional costs incurred in any transaction.

### Viewing

Strictly via prior appointment with the appointed agents:

Oliver Marshall 07887 787 885  
oliver@fhp.co.uk

Ed Purcell 07793 808974  
ed@creative-retail.co.uk

Owned and Managed by

Will Helm 07774 666805  
whelm@lcpproperties.co.uk

MISREPRESENTATION ACT, 1967 London & Cambridge Properties Limited (Company Number 02895002) the registered office of which is at LCP House, Pensnett Estate, Kingswinford, West Midlands DY6 7NA its subsidiaries (as defined in section 1156 of the Companies Act 2006) associated companies and employees ("we") give notice that: Whilst these particulars are believed to be correct no guarantee or warranty is given, or implied therein, nor do they form any part of a contract. [We do our best to ensure all information in this brochure is accurate. If you find any inaccurate information, please let us know and where appropriate, we will correct it.] We make no representation that information is accurate and up to date or complete. We accept no liability for any loss or damage caused by inaccurate information. [This brochure gives a large amount of [statistical] information and there will inevitably be errors in it]. Intending purchasers or tenants should not rely on the particulars in this brochure as statements or representations of fact but should satisfy themselves by inspection or otherwise as to the correctness of each of them. We provide this brochure free of charge and on the basis of no liability for the information given. In no event shall we be liable to you for any direct or indirect or consequential loss, loss of profit, revenue or goodwill arising from your use of the information contained herein. All terms implied by law are excluded to the fullest extent permitted by law. No person in our employment has any authority to make or give any representation or warranty whatsoever in relation to the property. SUBJECT TO CONTRACT. We recommend that legal advice is taken on all documentation before entering into a contract. You should be aware that the Code of Practice on Commercial Leases in England and Wales strongly recommends you seek professional advice from a qualified surveyor, solicitor or licensed conveyancer before agreeing or signing a business tenancy agreement. The Code is available through professional institutions and trade associations or through the website: <https://www.rics.org/uk/upholding-professional-standards/sector-standards/real-estate/code-for-leasing-business-premises-1st-edition/>. LCP's privacy notices that apply to its use of your personal information are at [www.lcpgroup.co.uk/policies](http://www.lcpgroup.co.uk/policies). The privacy notice that applies to you will depend on the nature of your relationship with LCP, and in some cases more than one may apply to you. LCP's privacy policy giving a high level overview of how LCP approaches data protection and your personal information can be found at [www.lcpproperties.co.uk/uploads/files/LCP-Privacy-Web-and-Data-Policy-May-2018.pdf](http://www.lcpproperties.co.uk/uploads/files/LCP-Privacy-Web-and-Data-Policy-May-2018.pdf).